

Point Hut Pond playground

Preliminary design

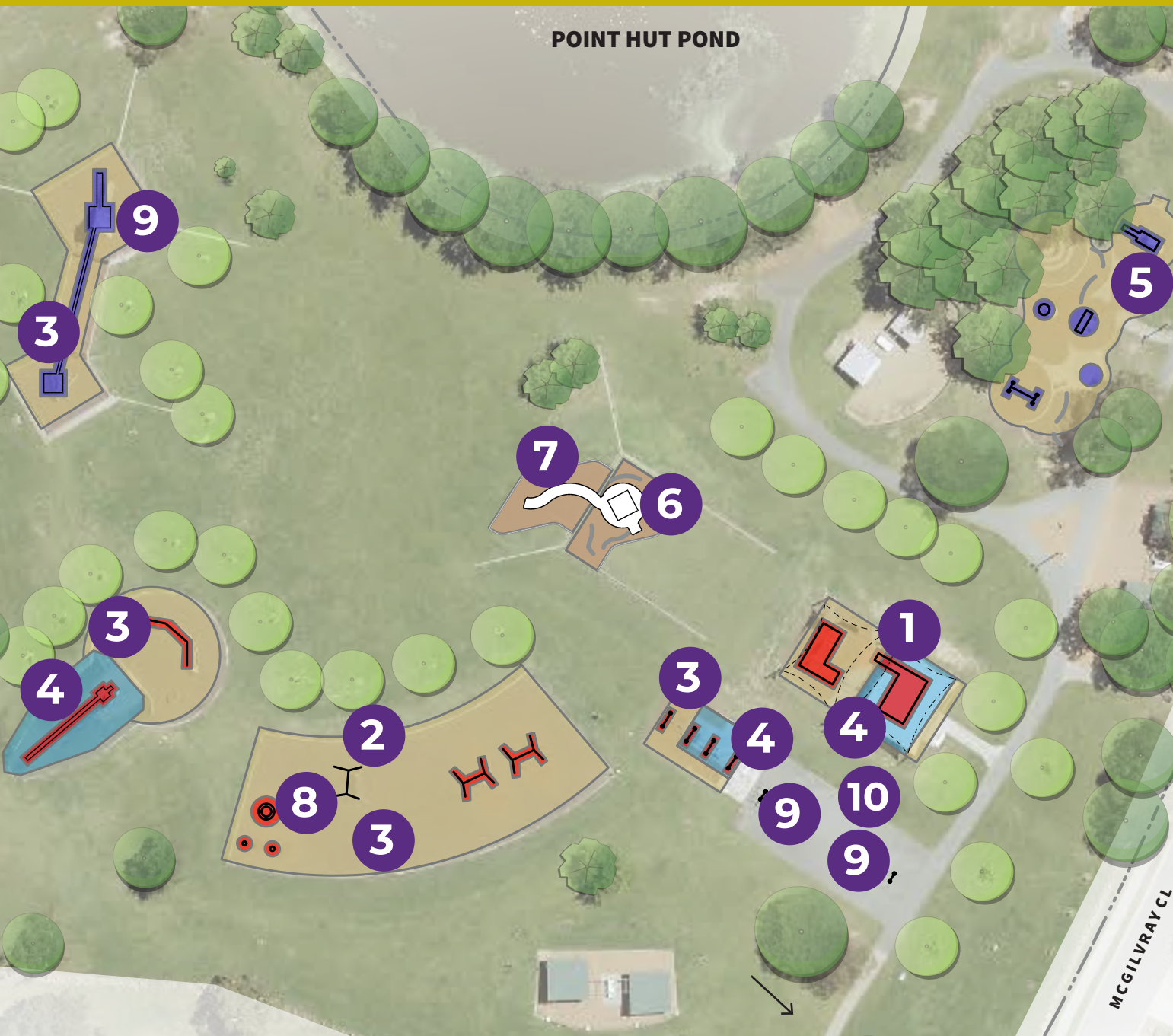

Map Key

- 1 Existing shade sails
- 2 Existing climbing net (to be removed)
- 3 Proposed top up of playground mulch
- 4 Proposed repairs to rubber softfall
- 5 Upgrades to existing junior play spacing including new equipment items (ages <4-7)
- 6 New climbing structure and slide (ages 4-13+)
- 7 New nature play area: includes boulder scramble slope and balance elements (ages 4-13+)
- 8 New climbing play equipment (ages 8-13+)
- 9 New artwork to equipment and basketball backboards
- 10 New bench seat